

GETTING TO KNOW THE FACULTY

Information for Incoming Students

Welcome!

Dear Students:

We'd like to welcome you to the Faculty of Social Sciences and Philosophy at the Philipps-Universität Marburg! We're happy that you have decided for a study period at our university and want to make your stay as agreeable as possible.

In choosing the Faculty of Social Sciences and Philosophy, you have opted for a faculty steeped in tradition, with prominent personalities such as Christian Wolff, Martin Heidegger, Hannah Arendt, Ernst-Otto Czempiel and Jürgen Habermas working and/or conducting research here. But this doesn't mean that our faculty got lost in its tradition – nowadays, our five departments and four independent centers offer a broad range of high-class teaching and research in the fields of cultural studies and social sciences. Find out more about the different research and teaching foci of our departments and centers by leafing through this brochure.

With regard to the Erasmus Programme and other exchange programmes, our faculty has established a new tradition: Over the past years, the numbers of outgoing and incoming students have always ranked among the top within Marburg University, emphasizing the importance of internationality at our faculty. Your visit will contribute to this priority and we're thankful for that!

This brochure is intended to provide you with all necessary information needed for your time at our faculty. For example, you'll find information about the Erasmus coordination, our departments and centers and important administrative regulations – please feel free to contact us if you find anything missing in here or if you have problems or questions during your stay. We're happy to assist you in every possible way!

Have a good time in Marburg and at our faculty!

A handwritten signature in black ink that reads "Mareike Stolley". The signature is written in a cursive, flowing style with a small hook at the end of the last name.

Your Erasmus Departmental Coordination

Your Erasmus Contacts

Erasmus Coordination at the Faculty of Social Sciences and Philosophy

Wilhelm-Röpke-Str. 6 F, 3rd floor, 35032 Marburg

Mareike Stolley

Tel.: +49 (0)6421 28-24939

Fax: +49 (0)6421 28-25542

erasmus03@staff.uni-marburg.de

Room: 03F01C

Office hours: Mondays 3-5 p.m.

<http://www.uni-marburg.de/fb03/studium/erasmus/incomings>

Markus Weber

Tel.: +49 (0)6421 28-24941

Fax: +49 (0)6421 28-25542

markus.weber@staff.uni-marburg.de

Room: 03F03

Office hours: Tue, Thu & Fri 10-11:30 a.m.

<http://www.uni-marburg.de/fb03/studium/studienberatung>

→ Please see her in case you need information or have problems regarding **courses** (e.g. ECTS credits) or the **faculty** in general. She is also responsible for signing your **“Belegliste”** at the end of your stay.

→ He is responsible for signing your **learning agreement** and your **changes**.

European Office

Biegenstr. 10, 2nd floor, 35032 Marburg

<http://www.uni-marburg.de/studium/res/erasmus/incomings>

Binja Homann

LLP/Erasmus student mobility

Room: 02 005

Tel.: +49 (0)6421 28-26236

Fax: +49 (0)6421 28-26077

homann@verwaltung.uni-marburg.de

Tilman Dörr

LLP/Erasmus Institutional Coordinator

Room: 02 006A

Tel.: +49 (0)6421 28-26226

Fax: +49 (0)6421 28-26227

erasmus@uni-marburg.de

→ Please contact these colleagues in cases of **general information or problems** regarding the Erasmus programme.

The Faculty of Social Sciences and Philosophy

...consists of **five different departments**:

Department for Comparative Cultural Research

The Department for Comparative Cultural Research is dedicated to teaching and research about various cultures of the world on an empirical basis and in a broadly comparative theoretical perspective. The department is divided into the two subject areas of Cultural and Social Anthropology and Study of Religions, each with its own traditions and specialties.

Please find further information on

http://www.uni-marburg.de/fb03/ivk/index_html

Department of European Ethnology/Cultural Studies

Teaching at the Department of European Ethnology/Cultural Studies addresses types of daily life routine and cultural phenomena in a European context, both historical and contemporary. Research is done on the empirical and discourse analytical studies of cultural phenomena, its focus lies on "Historical Anthropology", "Research on Europe", "Cultural Studies", and "History of Science and Methodology".

Please find further information on

http://www.uni-marburg.de/fb03/euroethno/index_html

Department of Philosophy

The Department of Philosophy is one of the oldest and most renowned departments at the Philipps-Universität Marburg. Its broad teaching offer and projects on essential topics of philosophical and interdisciplinary research gain wide recognition. Focus lies on research about Kant and the Philosophy of Enlightenment, including a critical Philosophy of Science. The Theoretical Philosophy in Marburg specialises in connecting different traditions and approaches, with research projects based on Analytical Philosophy, Phenomenology and Critical Theory.

Please find further information on

http://www.uni-marburg.de/fb03/philosophie/index_html

Department of Political Science

The Department of Political Science in Marburg is one of the oldest and largest in Germany. Today the department consists of ten professorships, one junior professorship and several research assistants. The distinguishing feature of the pluralistic and critical tradition of Political Science in Marburg is that not only does the department teach the well-established

branches of the subject, but they also offer innovations such as Gender Politics and Politics of the Near and Middle East.

Please find further information on

http://www.uni-marburg.de/fb03/politikwissenschaft/index_html

Department of Sociology

The Department of Sociology intends to realise a problem-oriented sociology with a socio-political claim that generates innovative theories based on methodological principles. It comprises six professorships, while its research and teaching focuses on three different areas: “Theories and Methodology”, “Conflict and Development” as well as “Political and Economical Sociology”. The sociology in Marburg is well-known for its interdisciplinary orientation and its diverse cooperations with partners within and beyond the scientific community.

Please find further information on

http://www.uni-marburg.de/fb03/soziologie/index_html

In addition, there are **four independent centers** that cooperate in teaching and research with the faculty’s regular departments:

Center for Conflict Studies (CCS)

The Center for Conflict Studies is a central facility of the Philipps-Universität, well-known for interdisciplinary collaboration and the study of peace and conflict. It combines various teaching and research activities that concentrate on central areas of societal and international conflict. The CCS focuses, inter alia, on “Intergroup Conflict and Violence”, “Peace-building and Transitional Justice”, “Development Cooperation and Peace”, “Civil Society in Conflicts”, and “Theories and Methods in Peace and Conflict Studies”.

Please find further information on

<http://www.uni-marburg.de/konfliktforschung>

Center for Gender Studies and Feministic Future Studies

The Center for Gender Studies and Feministic Future Studies is a central institution of the Philipps-Universität Marburg. Research and teaching comprises, inter alia, the future of labour and transformation of society, religion and gender as well as body, identity and health.

Please find further information on

<http://www.uni-marburg.de/genderzukunft>

Center for Interdisciplinary Study of Religions

The Center for Interdisciplinary Study of Religions pays attention to the increasing significance of religion and religions worldwide. It aims at strengthening the various research projects from different departments in Marburg by pooling them into one single center of excellence.

Please find further information on

<http://www.uni-marburg.de/zir>

Center for Near and Middle Eastern Studies (CNMS)

The CNMS is an interdisciplinary center for Area Studies which cooperates with the Faculty of Social Sciences and Philosophy. With a total of seven professorial chairs, a multitude of staff, and through a broad network, a unique range of possibilities in the field of Oriental Studies has emerged. By focussing on the MENA countries, Iran and Turkey, the CNMS aims to analyse the region in its overall context.

Please find further information on

<http://www.uni-marburg.de/cnms>

These departments and centers offer various **study programmes**:

Bachelor (B.A.) Programmes

- B.A. Comparative Studies of Cultures and Religions
- B.A. Philosophy
- B.A. Political Science
- B.A. Social Sciences

German Teaching Degrees

- Ethics
- Philosophy
- Politics and Economy

Master (M.A.) Programmes

- M.A. Politics and Economy of the Near and Middle East
- M.A. Europe: Integration and Globalisation
- M.A. Cultural and Social Anthropology
- M.A. European Ethnology/ Cultural Studies
- M.A. International Development Studies
- M.A. Peace and Conflict Studies
- M.A. Philosophy
- M.A. Political Science
- M.A. Sociology and Social Research
- M.A. Study of Religions

Please find links with detailed information on all these study programmes on

<http://www.uni-marburg.de/fb03/studium/studiengaenge>

Incoming students, no matter under which bilateral agreement they have come to our faculty, are welcome to choose their courses from all classes taught at the Faculty of Social Sciences and Philosophy. Please check with Mareike Stolley if you'd like to attend classes at other faculties.

Faculty of Social Sciences and Philosophy

In case you encounter problems or have questions regarding your chosen courses (e.g. course work etc.), it might be necessary to see one of our **student advisors**. However, your first contact person at the faculty level should remain your Erasmus coordinator **Mareike Stolley**.

Department of Philosophy

Dr. Ulrich Vogel, Wilhelm-Röpke-Str. 6 B, room 03B09

Tel.: +49 (0)6421 28-24717

E-mail: vogel@staff.uni-marburg.de

Department of Political Science

Dr. Ingrid El Masry, Wilhelm-Röpke-Str. 6, room 00G59

Tel.: +49 (0)6421 28-24384

E-mail: elmasry@staff.uni-marburg.de

Department of Sociology

Markus Weber → see Erasmus coordination, p. 2

B.A. Comparative Studies of Cultures and Religions & M.A. European Ethnology/Cultural Studies

Dr. Antje van Elsbergen, Biegenstr. 9, room 118

Tel.: +49 (0)6421 28-23783

E-mail: ave@staff.uni-marburg.de

M.A. Study of Religions & M.A. Cultural and Social Anthropology

Dr. Ulrike Bieker, Kugelgasse 10, room 24 or Landgraf-Philipp-Str. 4, room 010

Tel.: +49 (0)6421 28-24036 or -25355

E-mail: biekerul@staff.uni-marburg.de

Center for Conflict Studies

Prof. Dr. Susanne Buckley-Zistel, Ketzerbach 11, room 01.004

Tel.: +49 (0)6421 28-24507

E-mail: s.buckley-zistel@staff.uni-marburg.de

Prof. Dr. Thorsten Bonacker, Ketzerbach 11, room 01.003A

Tel.: +49 (0)6421 28-24574

E-mail: thorsten.bonacker@staff.uni-marburg.de

Faculty of Social Sciences and Philosophy

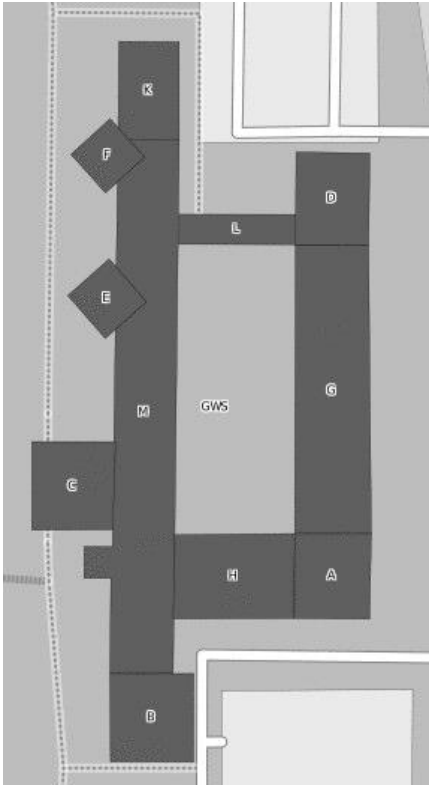

Source: OpenStreetMap, published under CC-BY-SA 2.0

Humanities building ("PhilFak")	
B	3 rd floor Department of Philosophy Seminar rooms 03B11 & 03B12
	4 th floor Sociology & Philosophy Library
	5 th floor Deanship and registrar's office Seminar rooms 05B10 & 05B11
F	03F01C Erasmus Coordination 03F03 Markus Weber 03F05 Center for Gender Studies
G	Department of Political Science Political Science Library Seminar rooms 00039 & 00052
H	01H01 Lecture hall

Academic Calendar	
Autumn ("Wintersemester"):	mid-October – mid-February
Spring ("Sommersemester"):	mid-April – mid-July

Further locations of the Faculty of Social Sciences and Philosophy:

Biegenstraße 9

Department of European Ethnology/Cultural Studies

Deutschhausstraße 12

Center for Near and Middle Eastern Studies (CNMS)

Ketzerbach 11

Department of Sociology & Center for Conflict Studies

Kugelgasse 10 ("Kugelhaus") & Landgraf-Philipp-Straße 4 („Alte Kanzlei“)

Department for Comparative Cultural Research

Administrative Regulations

Course selection and registration

Please find the complete course catalogue (“Vorlesungsverzeichnis”) of Philipps-Universität Marburg under “Direkt-Links” in the upper right corner of every university website. Incoming students are welcome to choose their courses from all classes taught at the Faculty of Social Sciences and Philosophy. If you’d like to attend classes at other faculties, please inform the respective lecturer and Mareike Stolley.

There is no regular, repetitive study programme in English available at our faculty, instead the courses change each semester. Especially the Departments of Political Science and Sociology as well as the Center for Conflict Studies offer several courses in English each semester. If you’d like to find all courses held in English at our faculty, please use the “Search for Lectures” in the online course catalogue and enter “FB 03 Gesellschaftswissenschaften und Philosophie” as department and, of course, “Englisch” as language of instruction.

You’ll need to register online within the given deadline for your chosen courses (“Anmeldung zu Lehrveranstaltungen”): Please log in on the course catalogue site with your Marburg student account and then use the button “belegen/abmelden” on every course description site. However, as an Erasmus student, you must not register online for your exams (“Prüfungsanmeldung”) like the regular Marburg students, your “Belegliste” will be a sufficient record of your academic work and grades.

Learning Agreement and Changes

Markus Weber (see p. 2) is responsible for signing your learning agreement and your changes. If you don’t know how many ECTS credits you will get for a certain course (sometimes there are several credits given on the online course catalogue), please check with your lecturer and/or Mareike Stolley – as a general rule you’d be given 2 ECTS credits for a lecture and 6 ECTS credits for a seminar.

“Belegliste” and Transcript of Records

The “Belegliste” is one of the most important documents of your Erasmus stay in Marburg because, at the end of your stay, your transcript of records will be issued according to the data on your “Belegliste”. You will find detailed information on how to get a transcript on <http://www.uni-marburg.de/studium/res/erasmus/incomings/howtotor.pdf>

Mareike Stolley will have to sign the list at the end – if you have not received all your grades before the end of your stay, you can deposit your list with Mareike Stolley and ask your lecturers to send your grades by e-mail to her office (erasmus03@staff.uni-marburg.de). She will then forward your list to Christian Hiebel who is responsible for issuing your final transcript of records.

Useful Terms and Abbreviations

AStA – Allgemeiner Studierendenausschuss: an executive body elected by the students of a university to represent their interests

Audimax – Auditorium **Maximum**, the largest lecture hall of the university (in the → HS)

c. t. – *cum tempore*: event/seminar starts quarter past (→ s. t.)

FB – Fachbereich: Faculty

HG – Hörsaalgebäude: the main lecture hall building located at Biegenstraße 14 (also: HSG)

HiWi/HK – Hilfswissenschaftler/Hilfskraft: (student) research assistant

HRZ – Hochschulrechenzentrum: service institution at the university responsible for computer and internet access

LA – Learning Agreement: see p. 8

LP – Leistungspunkte: credits assigned for classes at our faculty, usually equivalent with ECTS credits

OE/OP – Orientierungseinheit/Orientierungsprogramm: introductory course or tutorial for beginners at a department → highly recommended for Erasmus students!

PhilFak – Philosophische Fakultät: building with several humanities departments

PM – Pflichtmodul: basic module at introductory level, usually within a Bachelor's Degree

PolBib – Bibliothek Politikwissenschaft: Political Science Library

SE – Seminar: a seminar, at some departments still divided into Proseminar (introductory level) and Hauptseminar (advanced level)

SozBib – Bibliothek Soziologie: Sociology Library, also home to the Philosophy Library

s. t. – *sin tempore*: event/seminar starts at the exact time (→ c. t.)

SWS – Semesterwochenstunden: the amount of time a seminar or lecture is taught per week. "2 SWS" means that a seminar or lecture comprises two hours (90 minutes) per week during the lecture period ("Vorlesungszeit").

ToR – Transcript of Records: see p. 8

UB – Universitätsbibliothek: main university library

VL – Vorlesung: lecture

WPM – Wahlpflichtmodul: optional module, taken in order to specialise in certain fields

Please find additional information in the information brochure for foreign students on <http://www.uni-marburg.de/international/orientierungsheft.pdf>

Erasmus Coordination – Faculty of Social Sciences and Philosophy

Wilhelm-Röpke-Str. 6 F, room 03F01C
35032 Marburg

Tel.: +49 (0)6421 28-24939

Fax: +49 (0)6421 28-25542

E-mail: erasmus03@staff.uni-marburg.de

Web: <http://www.uni-marburg.de/fb03/studium/erasmus/incomings>